

SKUs: SMGEOSHNT1

# METAL AND WOOD GEOMETRIC SHELVING

*Assembly Instructions*

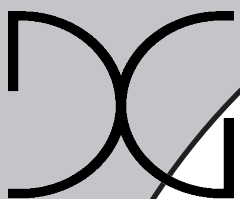

# DISPLAYS2GO

CONNECTING PEOPLE & BRANDS WITH THE WORLD

# PARTS DIAGRAM

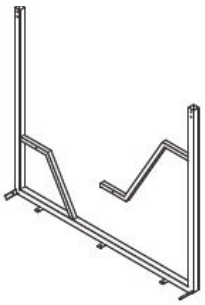

**A\*1**

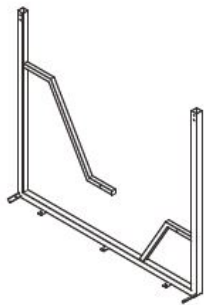

**B\*1**

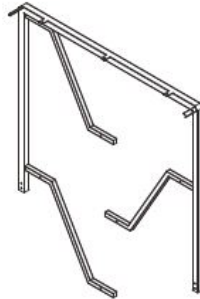

**C\*1**

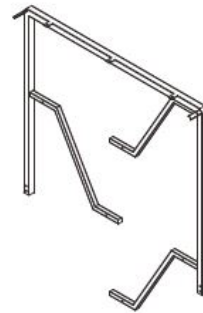

**D\*1**



**E\*4**



**F\*8**



**G\*4**

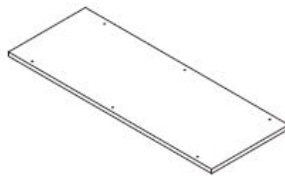

**H\*2**

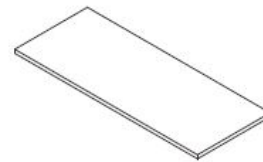

**O\*4**



**M**



**N**

If you have any questions regarding our products, please visit us at [www.displays2go.com](http://www.displays2go.com) or contact D2G customer service at 844-221-3388.

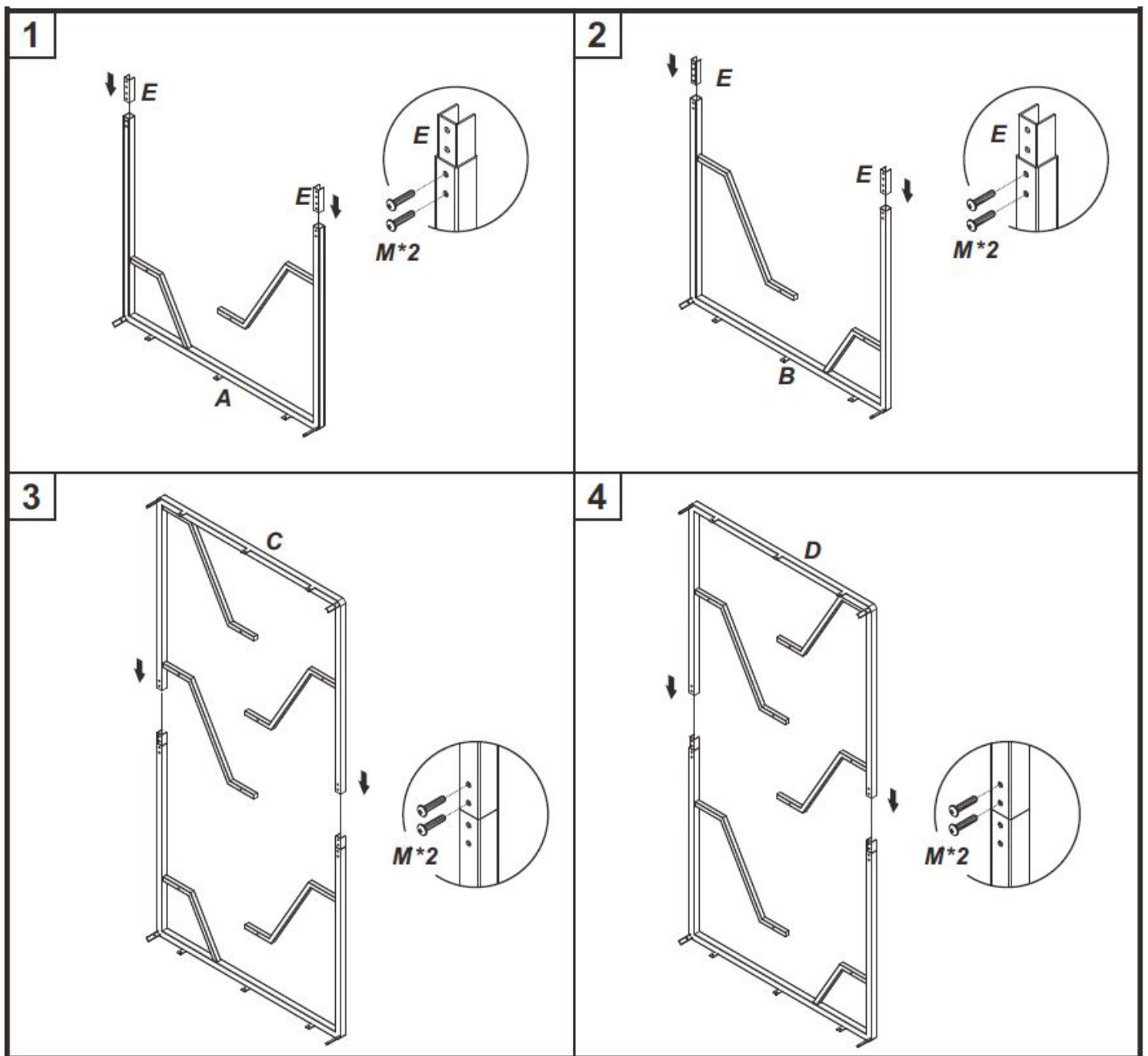

1. Slide (E) bracket onto the top of the first frame piece (A). Each side should have one bracket.
2. Repeat step 1 with frame piece (B), as depicted.
3. Screw top of frame (C) into the frame piece (A). Use two (M) screws per side.
4. Repeat step 3 with frame pieces (D) and (B), as shown.

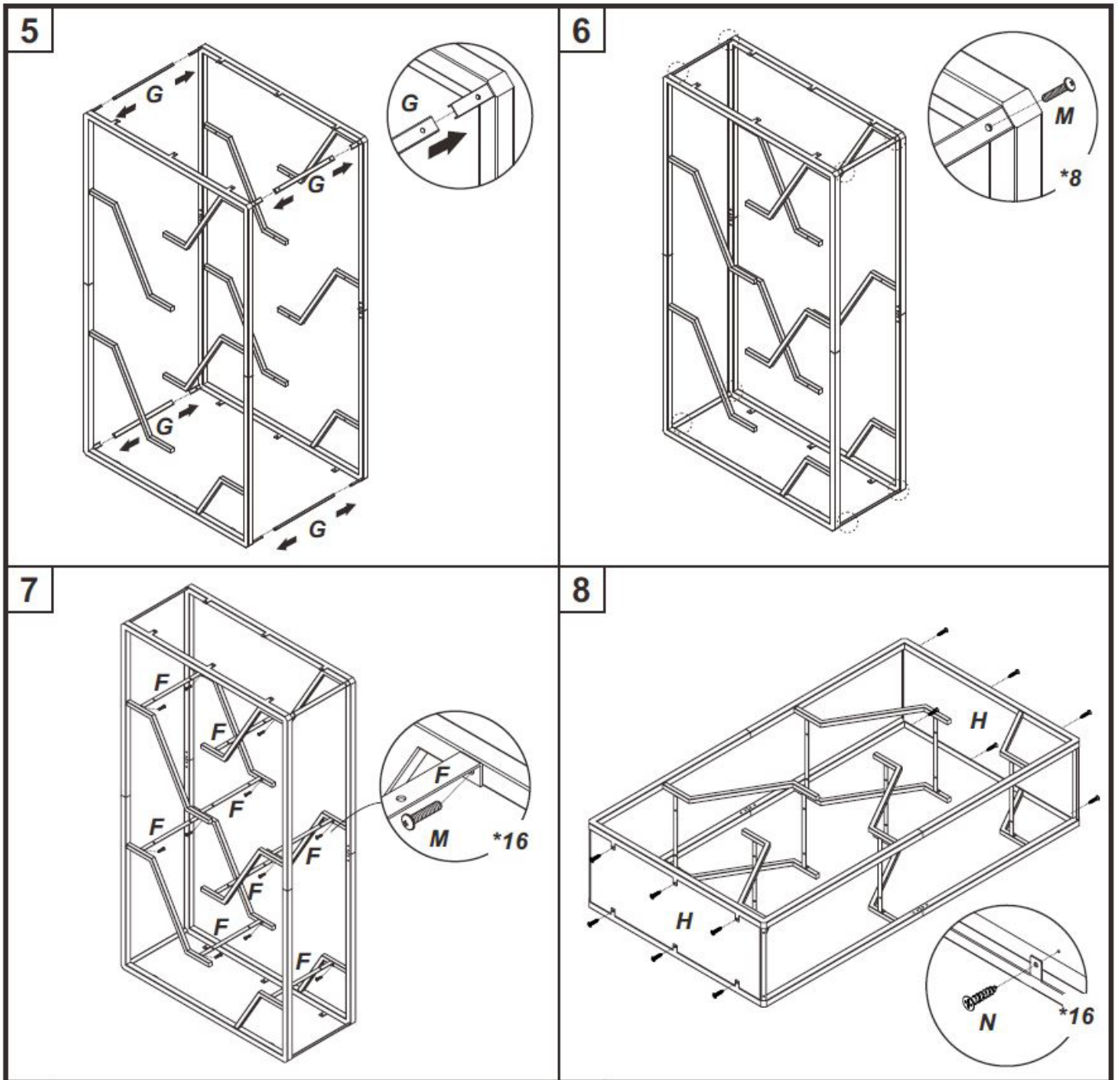

5. Using the four connection pieces (G), slide frames together, as depicted.

6. At the corners, use (M) screw to tighten and secure unit together.

7. Insert shelving support rods (F) and secure to frame with two (M) screws per support rod. Follow diagram to ensure correct placement.

8. With (N) screws, secure top and bottom panels to the unit. Six screws will be used on each side.

NOTE: For step 8, flip unit onto its side for easy access and to prevent damage to the unit.

9

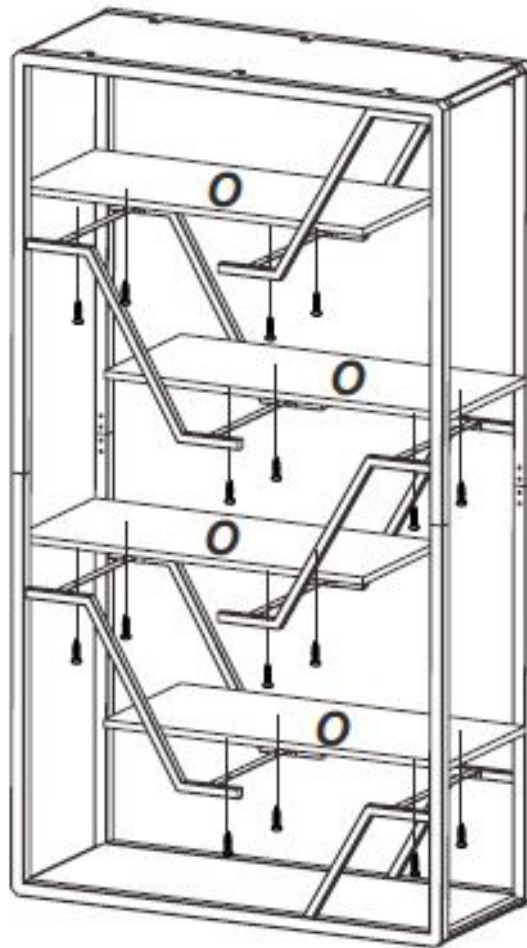

9. Slide shelving pieces (O) into the unit, as shown. Secure shelving to unit using four (N) screws per shelf.

NOTE: These screws will be inserted at the bottom of the shelf (SEE DIAGRAM).

Enjoy your new Geometric Shelving Unit!

